

NOTES:

1. THE CONTRACTOR SHALL BE RESPONSIBLE FOR HAULING OFF ANY SPOIL NOT USED AFTER FINAL GRADING.
2. TO PROVIDE A CONSISTENT SUBGRADE FOR SLAB SUPPORT AND REDUCE THE POTENTIAL FOR ACTIVE SOILS TO AFFECT THE PAVING, A UNIFORM LAYER OF DENSITY APPROVED SELECT FILL SHALL BE PROVIDED BENEATH THE PROPOSED PAVING.
3. SELECT FILL SHALL BE FREE FROM ORGANIC OR OTHER DELETERIOUS MATERIAL, HOMOGENEOUS MIXTURE, HAVE A MAXIMUM PARTICLE SIZE OF THREE INCHES, HAVE A LIQUID LIMIT LESS THAN 40 AND A PLASTICITY INDEX BETWEEN 8 AND 20, AND CONSIST OF OF SILTY-CLAYEY SANDS (SM-SC), LOW PLASTICITY SANDY CLAYS (CL), OR CLAYEY SANDS (SC) AS DEFINED BY THE UNIFIED SOIL CLASSIFICATION SYSTEM. IN ADDITION TO THE ABOVE REQUIREMENTS, THE MATERIAL SHOULD HAVE A MINIMUM OF 90 PERCENT RETAINED ON THE No. 200 SIEVE.
7. NO GRADING SHALL RESULT IN SLOPES STEEPER THAN 1 VERTICAL FOR 4 HORIZONTAL. ALL SLOPES AND FUTURE LAWN AREAS SHALL BE DRESSED WITH 3" OF TOPSOIL AND SHALL BE LIMED (200 LB/AC.), FERTILIZED (300 LB/AC) AND SEEDED IN ACCORDANCE WITH LSSRB LATEST EDITION.
8. ALL TESTING SHALL BE PERFORMED OR WITNESSED BY A REPRESENTATIVE OF GEOTECHNICAL TESTING LABORATORY INC. (318-443-7429). ALL FILL MATERIAL SHALL BE APPROVED BY AND TESTED FOR COMPACTION BY GEOTECHNICAL TESTING LABORATORY IN ACCORDANCE WITH GUIDELINES SET IN THE GEOTECHNICAL INVESTIGATION.
9. FONTENOT & ASSOCIATES WILL NOT PROVIDE CUT / FILL VOLUMES. IN THE EVENT THAT THE CONTRACTOR NEED SAID INFORMATION FONTENOT & ASSOCIATES WILL ISSUE CAD FILES FOR THIRD PARTY VOLUME CALCULATIONS.
10. FONTENOT & ASSOCIATES WILL NOT PROVIDE CONSTRUCTION LAYOUT ON THE SITE. THE CONTRACTOR SHALL CONTACT LODESTONE SURVEYING (MATTHEW PHILLIPS) FOR SITE LAYOUT / CONTROL WORK. THE CONTRACTOR SHALL BE RESPONSIBLE FOR ALL SURVEY FEES ASSOCIATED WITH LAYOUT / CONTROL.
11. CONTOURS AS SHOWN SHOULD BE CONSIDERED EXISTING GRADE. THE CONTRACTOR WILL NEED TO GRADE THE SITE TO ACHIEVE PAVING & GROUND ELEVATIONS SHOWN ON THE PAVING JOINT LAYOUT SHEET AND SITE GRADING SHEET.
12. AFTER ALL GRASS HAS BEEN FULLY ESTABLISHED THE CONTRACTOR SHALL PAINT ALL FIELD LINES SHOWN ON THIS SHEET WITH WHITE PAINT TO INCLUDE BASEBALL AND SOCCER FIELD LINES.

FIELD SPECIALTY EQUIPMENT SCHEDULE

EQUIPMENT	QTY.	DESCRIPTION
HOME PLATE	1	CHAMPION BH86 BURY ALL PLATE W/ RUBBER BASE
PITCHING RUBBER	1	CHAMPION BH81 4 WAY 6" X 24"
FOUL POLE	2	SEE DETAIL
BASES	3	SCHUTT MODEL 12901010
BASE ANCHORS	3	SCHUTT DIRECT BURY (SET IN CONCRETE)
BLEACHERS	2	FACTORY BUILT 3 ROW X 12 FT LENGTH 6063-T6 ALUMINUM ALLOY WITH 204R1 ANNODIZED FINISH. UNIT SHALL HAVE 2" X 10" SEATS. ALL SEATS ALUMINUM CAPS BLEACHERS SHALL BE SECURED TO SLAB WITH MIN. 3" EXPANSION ANCHORS.
DUGOUT BENCH	2	15 FT 6063-T6 ALUMINUM ALLOY WITH 204R1 ANNODIZED FINISH. UNIT SHALL HAVE TOP SHELF (18" MIN.) AND 2" X 10" SEAT. ALL SEATS AND SEAT BACKS SHALL HAVE RIVITED ALUMINUM CAPS
CORNER FLAGS FOR SOCCER FIELD	4	FORZA BRAND OR EQUAL SET OF 4 (50 mm) X 5 FT HIGH CORNER FLAGS WITH METAL GROUND SLEEVES. PROVIDE GROUND SLEEVE MARKERS FOR EACH SOCKET.
ALUMINUM SOCCER GOAL	2	PEVO COMPETITION SERIES GOAL OR EQUAL - GOAL SHALL BE CONSTRUCTED OF LIGHTWEIGHT ALUMINUM WITH 4 INCH ROUND TUBING THAT IS POWDER COATED WHITE. GROUND BARS SHALL BE GALVANIZED STEEL. THE GOAL SHALL BE PRE-DRILLED FOR NET ATTACHMENT AND SHALL HAVE ANCHOR KIT, & WHEEL KIT.

NOTE: SUBMITTALS WILL BE REQUIRED FOR ALL ACCESSORIES IN SCHEDULE

FIELD FENCE SCHEDULE

FENCE TYPE	QUANTITY
20 FT BACKSTOP FENCE	80 FEET
6 FT FENCE W/ 3 STRAND WIRE	530 FEET



Know what's below
Call 811 before you dig

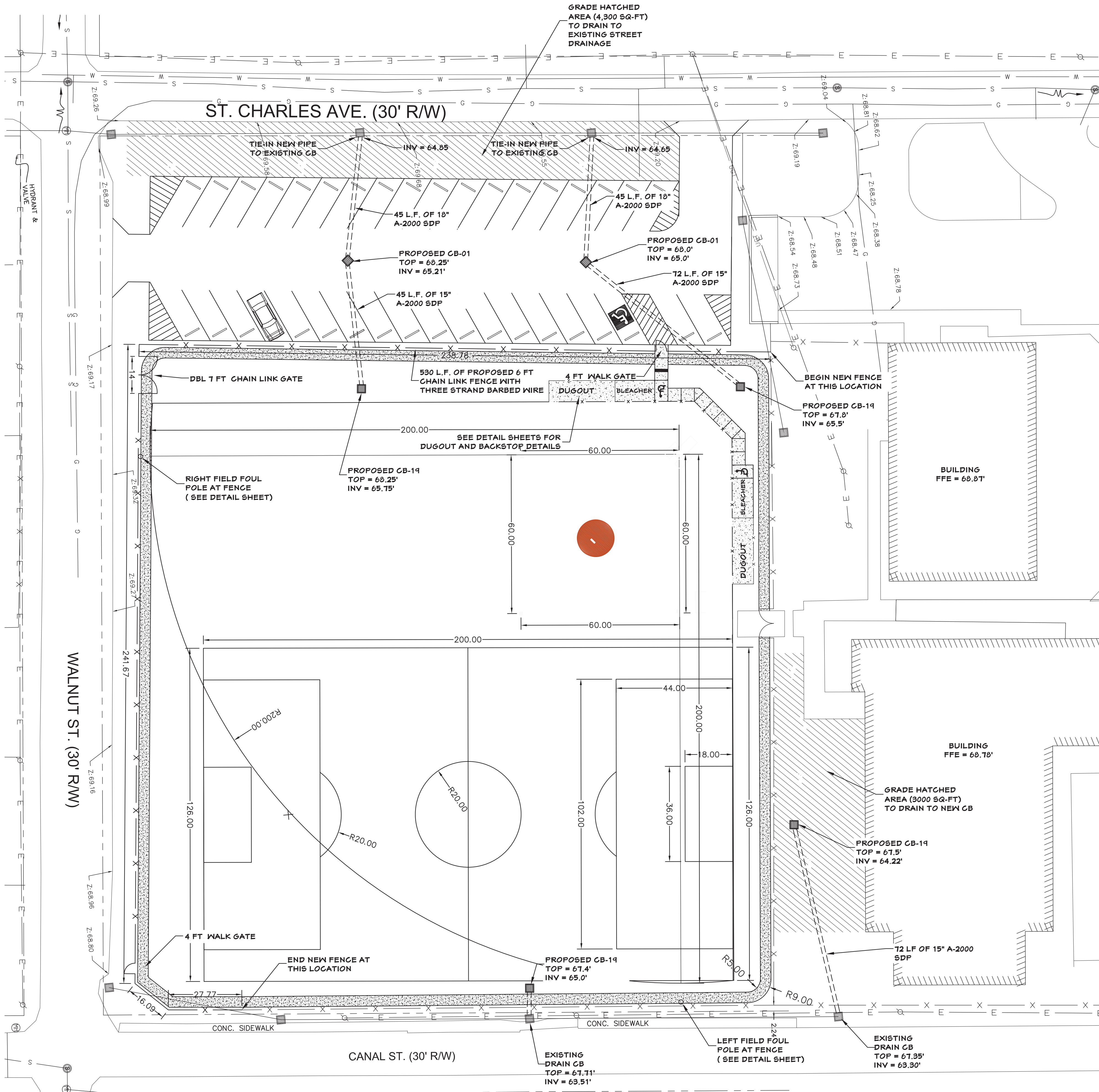

PROPOSED FIELD & PARKING LAYOUT
SCALE: 1" = 20'

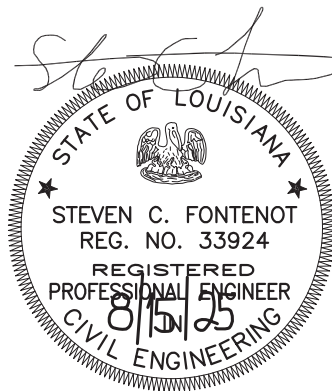
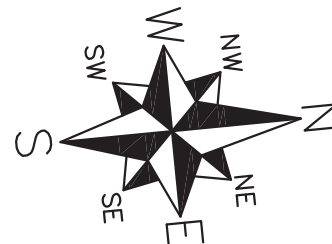

1439 Centre Ct., Ste 401
Alexandria, LA 71301
Ph: 318.445.3151
Fx: 318.445.3988
Em: adg@adgllc.net

Fontenot & Associates, LLC

2025 Jackson Street
Alexandria, LA 71301
Office: 318.427.7808

CONSULTANT (IF APPLICABLE)

PHASE 2 - RENOVATIONS TO
CARTER C. RAYMOND
JUNIOR HIGH SCHOOL
2510 SAINT CHARLES AVE, LECOMPTE, LA 71346

SCF
SCF
08.15.25

PROJECT NO:
DRAWN:
CHECKED:
DATE:
LAST REV:

C-102

© 2024, Alliance Design Group, LLC. All rights reserved.